

RE ZONING PLAN FOR THE ALTA INDEPENDENCE, JACKSON COUNTY, MISSOURI

DEVELOPER/OWNER:

RW BOLGER SQUARE LLC
363 WEST LANCASTER AVE.
WAYNE PA 19087
PHONE: 610-715-2399

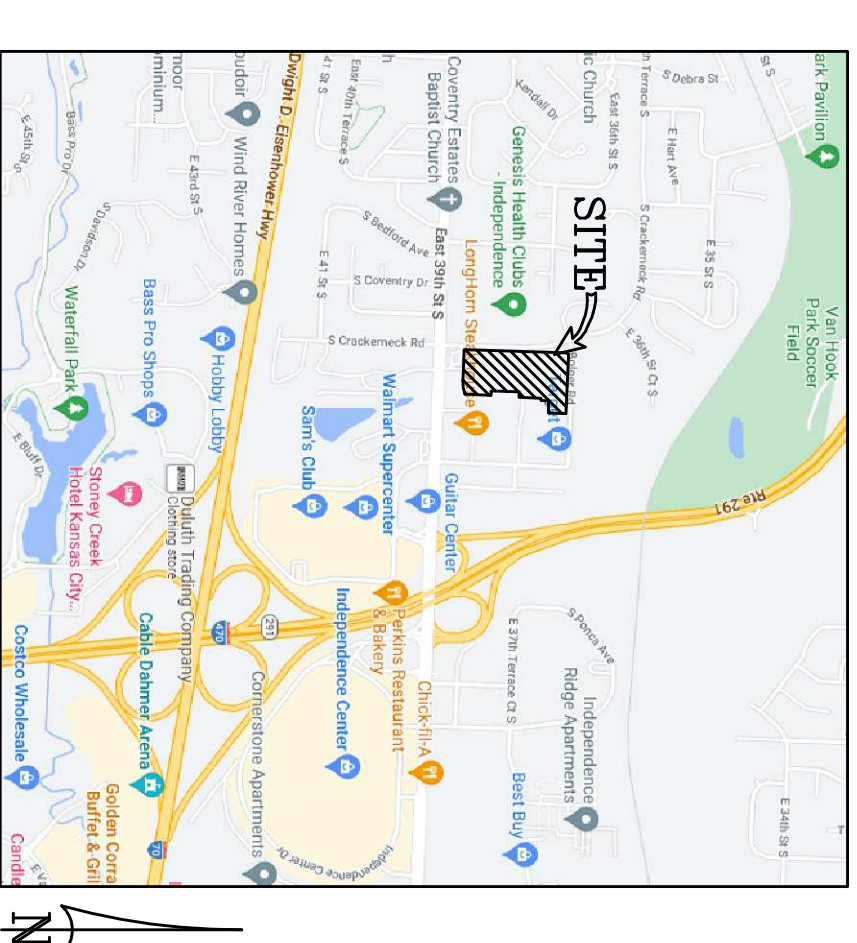

LOCATION MAP

RECORD DESCRIPTION

THE LAND REFERRED TO HEREIN BELOW IS SITUATED IN THE COUNTY OF JACKSON, STATE OF MISSOURI, AND IS DESCRIBED AS FOLLOWS:
A TRACT OF LAND BEING LOT 3, THE RESUBDIVISION OF LOTS 2 AND 3 OF BOLGER SQUARE, A SUBDIVISION IN THE CITY OF INDEPENDENCE, JACKSON COUNTY, MISSOURI AND BEING MORE PARTICULARLY DESCRIBED AS FOLLOWS:
BEGINNING AT THE INTERSECTION OF THE NORTH LINE OF OUTLOT "A" OF BOLGER SQUARE RECORDED IN DOCUMENT NUMBER 98-1-15411, JACKSON COUNTY RECORDS WITH THE EAST LINE OF THE NORTH LINE OF LOT 3, A DISTANCE OF 45 MINUTES 52 SECONDS EAST, A DISTANCE OF 946.66 FEET TO A POINT OF TANGENCY IN THE SOUTH LINE OF BOLGER (50'W) ROAD; THENCE ALONG SAID EAST LINE, NORTH 01 DEGREES 52 SECONDS EAST, A DISTANCE OF 946.66 FEET TO A POINT OF TANGENCY IN THE SOUTH LINE OF BOLGER (50'W) ROAD; THENCE ALONG SAID SOUTH LINE ALONG A TANGENT CURVE TO THE RIGHT HAVING A RADIUS OF 100 FEET, AN ARC DISTANCE OF 117.62 FEET TO THE WEST LINE OF BOLGER ROAD, SOUTH 87 DEGREES 43 MINUTES 03 SECONDS EAST, A DISTANCE OF 5511.37 FEET TO THE WEST LINE OF LOT 2 OF THE BOLGER SQUARE RESUBDIVISION RECORDS 3 OF BOLGER SQUARE AS RECORDED IN PLAT BOOK 1-63 PAGE 20, JACKSON COUNTY RECORDS;
THENCE ALONG SAID WEST LINE THE FOLLOWING COURSES AND DISTANCES:
SOUTH 02 DEGREES 19 MINUTES 43 SECONDS WEST, A DISTANCE OF 188.51 FEET;
SOUTH 87 DEGREES 43 MINUTES 18 SECONDS WEST, A DISTANCE OF 302.20 FEET;
SOUTH 02 DEGREES 19 MINUTES 43 SECONDS WEST, A DISTANCE OF 73.75 FEET;
NORTH 87 DEGREES 49 MINUTES 17 SECONDS WEST, A DISTANCE OF 22.65 FEET;
NORTH 87 DEGREES 49 MINUTES 17 SECONDS WEST, A DISTANCE OF 73.75 FEET;
NORTH 87 DEGREES 49 MINUTES 17 SECONDS WEST, A DISTANCE OF 5113.59 FEET;
SOUTH 02 DEGREES 19 MINUTES 43 SECONDS WEST, A DISTANCE OF 287.22 FEET;
SOUTH 87 DEGREES 49 MINUTES 18 SECONDS EAST, A DISTANCE OF 42.87 FEET;
SOUTH 87 DEGREES 49 MINUTES 18 SECONDS EAST, A DISTANCE OF 42.87 FEET TO THE NORTHERLY LINE OF OUTLOT "C" AS RECORDED IN PLAT BOOK 1-63 PAGE 20, JACKSON COUNTY RECORDS;
THENCE ALONG SAID NORTHERLY LINE AND THE NORTHERLY LINE OF OUTLOT "B" AND THE NORTHERLY LINE OF OUTLOT "A" OF BOLGER SQUARE, A DISTANCE OF 1885 FEET TO POINT OF BEGINNING 1885' ALONG A CURVE TO THE LEFT HAVING A RADIUS OF 214.00 FEET, AN ARC DISTANCE OF 5.36 FEET TO A POINT OF BEGINNING 1885' ALONG A CURVE TO THE RIGHT HAVING A RADIUS OF 300.00 FEET, AN ARC DISTANCE OF 117.62 FEET TO THE WEST LINE OF BOLGER ROAD, SOUTH 87 DEGREES 43 MINUTES 03 SECONDS EAST, A DISTANCE OF 5511.37 FEET TO THE WEST LINE OF LOT 2 OF THE BOLGER SQUARE RESUBDIVISION RECORDS 3 OF BOLGER SQUARE AS RECORDED IN PLAT BOOK 1-63 PAGE 20, JACKSON COUNTY RECORDS;
APN: 34-310-04-17-00-0-00-000, 34-310-04-18-00-0-00-000 AND 34-310-04-20-00-0-00-000

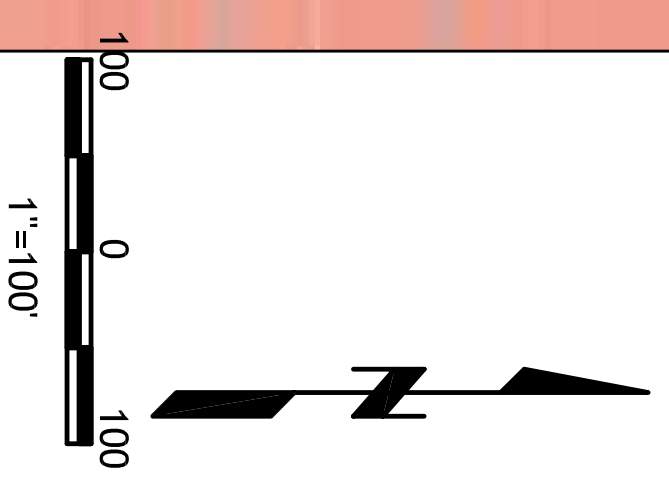
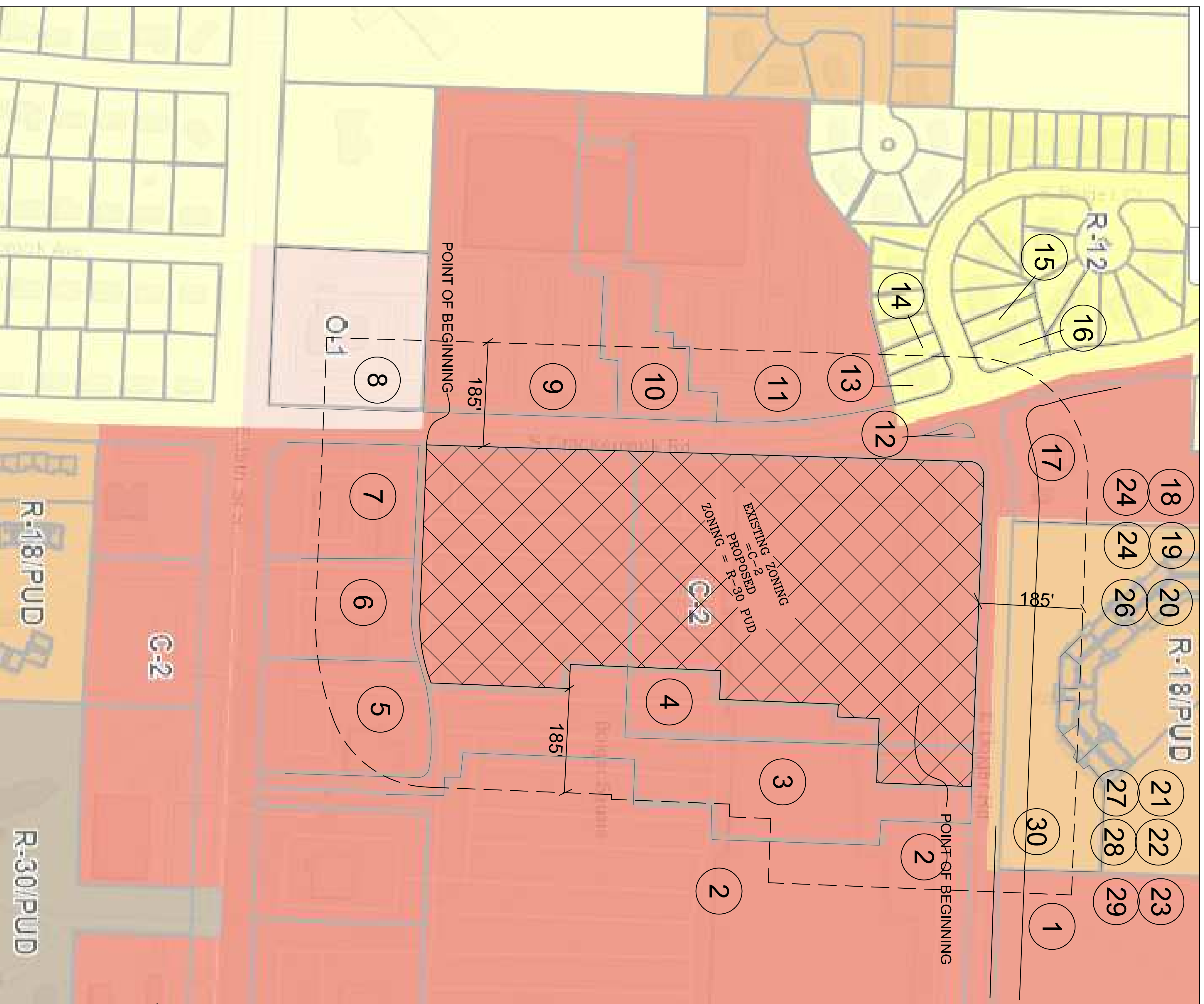

Quist Engineering, Inc
Civil Engineering for Residential & Commercial Site Development
821 NE Columbus St.
Lee's Summit, Missouri 64063
Phone: (816) 550-5675
email: rwalquist@quistengineering.com

THE ALTA INDEPENDENCE, JACKSON COUNTY, MISSOURI

COPYRIGHT © 2023
ISSUE: 4-27-23
REVISIONS:
7-23-20
4-19-21

SHEET NO.
C200

PROJECT CONTACTS: ROBERT WALQUIST, P.E.,
KEES SUMMIT (MISSOURI)
PHONE: (816) 550-5675

JOB NO.
E22-328

RE ZONING PLAN