



Liquor License Application Form

Regulated Industries Division
111 E. Maple Avenue
Independence, MO 64050
(816) 325-7079
blicenses@indepmo.org

Application Type: [ ] Package [x] Drink [ ] Manufacturing [ ] Wholesale [ ] Special [ ] Ownership Change

Business Information

This Business is a: [ ] Sole Proprietor [ ] Partnership [ ] LP [x] LLC [ ] Corporation

Legal Name of Entity: IND Hotel Partners, LLC
Type of Business: Hotel

Doing Business as (d/b/a) (if different than above): Hilton Garden Inn - Independence MO

Physical Address: 19677 E Jackson Drive
City: Independence
State: MO
Zip: 64057

Mailing Address (if different from above): 4045 E Sunshine, STE 200, Springfield MO 65809

Phone: 816-350-3000
Cell Phone:
Email: accounting@ohospitalitymanagement.com

State & Date of Incorporation or Organization: Missouri 04/29/2021
Missouri Retail Sales Tax Number: 27198227

Date business scheduled to open:

Give dimensions or square footage of the building, outdoor patio, and any other areas in which alcoholic beverages may be stored or dispensed: 122,000 sq ft

Is the proposed location within 300 feet of a church, school, or hospital? NO

Proposed hours of operation: 7 days per week / 3pm - 11pm

If existing business, from whom was the business purchased? Freedom Lodging, LLC

Date of purchase: 06/03/2021
Date of Possession: 06/03/2021

Does the former owner of the business have any interest, either directly or indirectly, in the business for which you seek a license? If so, explain:

None

I hereby apply to the City of Independence, MO, for the following license(s) for the business and premises described above (mark all license types for which you are applying on page 2). I also certify that the information given in this application is true to the best of my knowledge and that the license is non-transferable. I also agree that this business will observe the restrictions specifically enumerated in Chapter 2 of the Independence City Code related to alcoholic beverages.

Signature of Applicant: [Handwritten Signature]
Printed Name: Tim O'Reilly
Title: Manager
Date: 2/22/24

**Liquor License Types (mark all license types for which you are applying)**

*All liquor licenses are effective for one (1) year, beginning July 1 and ending June 30. Any liquor license application made between January 1 and March 31 will be charged a prorated fee equal to one-half of the annual license fee (listed below). Those licenses will expire June 30 of that year. Applications made between April 1 and June 30 will be charged the full license fee (listed below), however those licenses will expire June 30 the following year.*

**Package Liquor Licenses**

- P1 – Retail Selling of Intoxicating Liquor of all kinds in the original package (\$150.00)
- P3 – Retail Selling of Beer only in the original package; includes Sunday Sales (\$150.00)
- S – Sunday Sales (\$300.00)
- T – Tasting Permit (\$25.00)

**Drink Licenses**

- T1 – Retail Selling of Intoxicating Liquor by the Drink (\$450.00)
- T2 – Retail Selling of Malt Liquor & Wine by the Drink (\$150.00)
- T3 – Retail Selling of Beer by the Drink; includes Sunday Sales (\$150.00)
- R1 – Restaurant Selling Intoxicating Liquor (\$450.00)
- R2 – Restaurant Selling Beer; includes Sunday Sales (\$150.00)
- F1 – Tax Exempt Organizations Selling Intoxicating Liquor (\$300.00)
- H1 – Hotel Selling Intoxicating Liquor (\$450.00)
- Z1 – Consumption of Intoxicating Liquor (\$150.00)
- S – Sunday Sales (\$300.00)

**Manufacturing, Distilling, Blending Licenses**

- M1 – Manufacturing, Distilling, Blending Intoxicating Liquor of all kinds (\$300.00)
- M2 – Manufacturing twenty-two (22) percent or less alcohol- content intoxicating liquor (\$300.00)
- M3 – Manufacturing, Brewing Malt Liquor (\$300.00)

**Wholesale Licenses**

- W1 – Wholesale selling of Intoxicating Liquor of all kinds (\$300.00)
- W2 – Wholesale selling of twenty-two (22) percent or less alcohol-content intoxicating liquor (\$300.00)
- W3 – Wholesale selling of malt liquor (\$300.00)

**Special Licenses**

- S1 – Microbrewery (\$7.50 per 100 barrels produced)
- S2 – Domestic Winery (\$7.50 per 500 gallons produced)
- S4 – Picnic 7 Day Intoxicating Liquor by the Drink (\$15.00 per day)
- S6 – July 4<sup>th</sup> Celebration Malt Liquor & Light Wine by the Drink (\$15.00 per day)
- C1 – Caterer Intoxicating Liquor by the Drink – Up to 7 Days (\$15.00 per day)
- C2 – Caterer Intoxicating Liquor by the Drink – Up to 50 Days (\$500.00)
- C3 – Caterer Intoxicating Liquor by the Drink – Unlimited Days (\$1,000.00 per day)



# Liquor License Application Form

Regulated Industries Division  
 111 E. Maple Avenue  
 Independence, MO 64050  
 (816) 325-7079  
 blicenses@indepmo.org

## Managing Officer, Sole Owner, or Managing Partner Information

Timothy O'Reilly							[REDACTED]
Full Name							Social Security Number
M	55	6'2"	180lbs	[REDACTED]	Joplin, MO	Yes	
Sex	Age	Height	Weight	Date of Birth	Place of Birth	Are you a U.S. Citizen	
4263 E Farm Lane Rd			Springfield		MO	65809	
Home Address			City		State	Zip	
Place of Employment (other than business)			Employment Phone		Email		
Employment Address		City		State	Zip		

City or Town where the Managing Officer, Sole Owner, or Managing Partner pays taxes:

Springfield MO

Will this person be in active control and management of this business? Please explain (part-time/full-time, etc.):

YES

Have you, any partner or employee ever been arrested anywhere in the United States for the violation of any City, State or Federal Law? If so, who, where, when and what offense (do not include minor traffic offenses):

NO

Have you, any partner or employee ever been the holder of a license to manufacture or sell alcoholic beverages, which was revoked? If so, explain:

NO

Have you, or any member of your household or immediate family, ever made application for a permit for the Director of Liquor Control that was denied? If so, explain and provide approximate date of denial:

NO

Do you rent or lease the premises for which this business is to be used? If so, give terms of rent or lease, and name and address of property owner:

NO

**Partnership or Member Information (complete only for partnerships or LLCs with multiple members)**

Give partnership or LLC name (if not already listed above) and the name, address, and percentage ownership interest of each partner or member:

Timothy O'Reilly - 70% 4045 E Sunshine, STE 200, Springfield MO 65809

Lotus Holdings, LLC - 30%

**Corporate Information (complete only for a corporation)**

List full name, complete address, phone number, date of birth and Social Security Number of all corporate officers:

President: \_\_\_\_\_

Vice President: \_\_\_\_\_

Secretary: \_\_\_\_\_

Treasurer: \_\_\_\_\_

Managing Officer: Timothy O'Reilly

Names, address, and phone number of shares owned of all stockholders who hold 10% or more of the capital stock:

\_\_\_\_\_

Is the corporation or any stockholder or the managing officer thereof, or any member of his/her household or immediate family, have interest directly in any other permit issued by the Director of Liquor Control? If so, explain:

\_\_\_\_\_

Has any stockholder of the corporation or an officer ever been employed by any person, partnership, or corporation that had a license revoked or suspended? If so, who, where, when and what offense:

NO

**Alcoholic Beverage Code Certifications – Adult Materials**

- I certify this establishment **will not** display or sell books, photos, magazines, videos, or other periodicals which are distinguished or characterized by the principal emphasis on matters depicting, describing, or relating to specified sexual activities.
- I certify this establishment **will** display or sell books, photos, magazines, videos, or other periodicals which are distinguished or characterized by the principal emphasis on matters depicting, describing, or relating to specified sexual activities.

**Alcoholic Beverage Code Certifications – Allow Entry for Inspection**

- I agree that I will permit the entry of any officer or investigator who has legal authority for the purpose of inspection; and will permit the removal of all things and articles which may be in violation of the ordinances of Independence, Missouri, and the laws of the State of Missouri or the United States.

**Alcoholic Beverage Code Certifications – Restaurant Liquor Sales**

- If qualifying as a restaurant:** I certify that at least 50% of the gross sales of the business for which this license application is made will consist of food.

**Alcoholic Beverage Code Certifications – Package Liquor Sales**

**If applying for a package liquor license:** I certify that, at all times, I will keep a stock of goods having a value according to my original invoices of at least one thousand dollars (\$1,000.00), exclusive of the inventory value of the fixtures and of the intoxicating liquor, which I shall offer for sale on said premises. Check one of the following:

- This location will have alcohol sales that are less than 90% of gross store sales.  
 This location will have alcohol sales that are more than 90% of gross store sales.

**Additional Documentation Required**

1. Letter of Explanation – Letter explaining why the application is being submitted by outlining the operations of the business and the use of the liquor license, should it be approved.
2. A recent photo of the Managing Officer.
3. Criminal Record Check – Missouri Highway Patrol criminal record check for the Managing Officer, Sole Owner, or each partner or member of a partnership or LLC.
4. Copy of the Managing Officer's paid Missouri personal property tax receipt for year immediately preceding the date of application.
5. Copy of Missouri voter registration card for the Managing Officer.
6. Recent photos of the interior and exterior of the premises to be licensed. If the building is under construction, the applicant shall provide a copy of the plans and specifications of the building.
7. Floorplan of the premises to be licensed including any areas where alcoholic beverages will be stored, sold, or consumed including outdoor patio areas.
8. Copy of Jackson County Business Property Tax receipt for year immediately preceding date of application. (If the business was new after January 1 of that year, it is exempt from this requirement.)
9. Business License Application – Applicant must submit a Business License application that includes a letter of "No Tax Due" dated within the previous 90-days for the MO sales tax number provided and a certificate of liability insurance.
10. License Fee: Check or money order payable to the City of Independence. See page 2 for current annual license fees.

*Please return this application and all required documents to the Regulated Industries Division at the address above. For questions about completing this application, please contact Jordan Ellena at [JEllena@indepmo.org](mailto:JEllena@indepmo.org) or by phone at 816-325-7183.*



4045 East Sunshine, Suite 200 | Springfield, MO 65809  
Phone: 417.851.8700 | Fax: 417.881.8225  
www.ohospitalitymanagement.com

---

February 13, 2024

To whom it may concern,

Submission of this application for a liquor license is to sell individual packaged liquor at the gift shop, liquor by the drink at the bar, including room service. We will also have bar service in our Conference Center for any Banquets requiring that service.

Thank you,

A handwritten signature in blue ink, appearing to read "M. O'Reilly". The signature is fluid and cursive, with a long horizontal stroke extending to the right.

*We do whatever it takes to make every guest smile!*





## No Match Notification

A statewide search of the identifiers below has revealed no criminal conviction or sex offender information on file. Fingerprints were not provided and thus the result of the search cannot be guaranteed.

Date of Search: 02/14/2024

Name (1): TIMOTHY OREILLY

Name (2):

Name (3):

Date Of Birth: [REDACTED]

SSN: [REDACTED]

Control Number: 6679589

If you have any questions, please do not hesitate to contact our office at 573-526-6153.

Missouri State Highway Patrol  
Criminal Justice Information Services Division  
PO BOX 9500  
Jefferson City, MO 65102

# Greene County Personal Property Receipt

## Tax Year 2023

### Property Description

2003 BOAT TRL2 1995 UTLT TRL1  
2017 BOAT TRL1 19BEF1419HCA17027 3 more items totaling \$530.00  
2011 ROAD RV 1 WDYPF4CC9A5471034  
1990 HARL MC 1  
2018 KIA NIRO KNDCC3LD9J5148334  
2017 FORD EXPL 1FM5K8F88HGA34973  
2001 BMW 3 SE WBABS53411EV85378  
2006 UTLT TRL1 129BU16236M001518  
2016 FORD F150 1FTEW1EG9GKE24243

**Date Paid** 12/29/2023  
**Receipt Number** 356903  
**Transaction** 23253646  
**This Payment** \$1,885.53  
**Account Number** 12-196-585

46

02/09/2024

### Where Your Taxes Go

STATE	\$10.70	COUNTY	\$36.52
DISABLED	\$15.98	OTC	\$66.72
ROAD	\$36.55	SENIOR SRV	\$16.83
LIBRARY	\$83.02	LR FIRE	\$200.41
SPR R12	\$1,418.80		



OREILLY, TIM  
4263 E FARM LANE RD  
SPRINGFIELD, MO 65809-3806

Allen Icet, Collector of Revenue Greene County Courthouse 940 N Boonville Ave, Springfield, MO 65802

Greene County Clerk's Office  
Richard T. Struckhoff  
940 Boonville Ave  
Springfield Mo 65802

OFFICIAL  
ELECTION MAIL  
Authorized by the U.S. Postal Service

**RETURN SERVICE REQUESTED**

To vote you must present a form of identification from the following list: an ID issued by the state of Missouri including a state agency, a local election authority of Missouri, the US government, or an institution of higher education of Missouri; a copy of a current utility bill, bank statement, government check, paycheck or other government document with your name and address; a driver's license or state identification card issued by another state; or an affidavit signed by you and two supervising election judges, one from each major political party, stating the election judges personally know you.

**Voting Location**

GLENDALE CHRISTIAN CH  
2110 S BLACKMAN RD  
SPRINGFIELD MO 65804

**Election Districts**

State Senate District 30  
State House District 140  
COUNTY COMMISSION DISTRICT TWO  
SPRINGFIELD R12  
LOGAN-ROGERSVILLE DISTRICT

**VOTER IDENTIFICATION CARD -- DO NOT DISCARD**

**This is a Voter Identification Card**

**Greene County**

**Voter ID # : 31101165**

**Ward/Precinct : 680.01 - CLAY C**

**County Registration Date : 09/10/1996**

**OREILLY, TIMOTHY B**

**4263 E FARM LANE RD  
SPRINGFIELD MO 65809**



Hilton  
Garden Inn

19677





*path can take you anywhere...*





**BREAKFAST HOURS**  
MON - FRI  
4:00a - 10:30a  
SAT - SUN  
4:30a - 10:30a  
Hours are subject to change.

↑ Banquet Room  
↓ Meeting Rooms









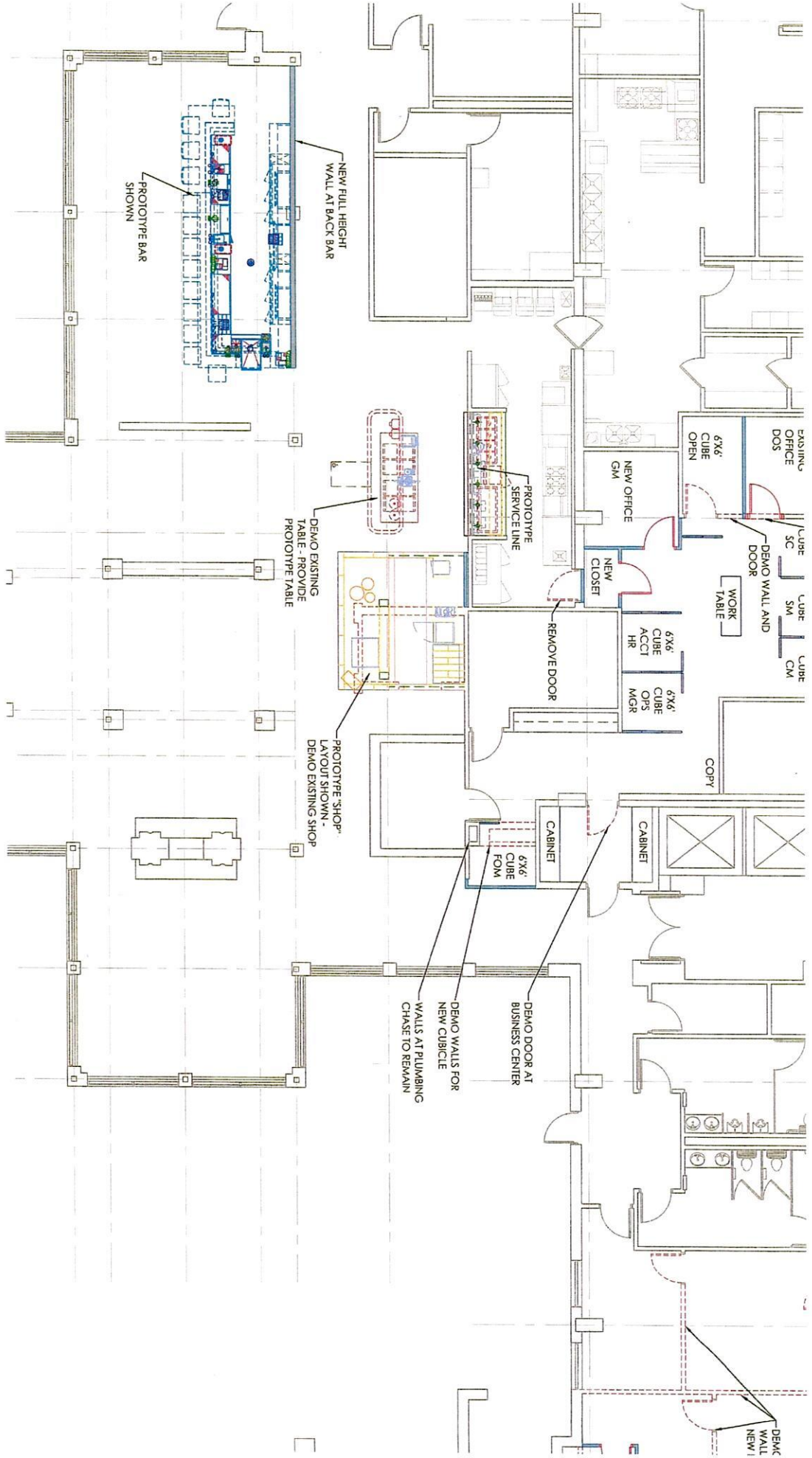

PROTOTYPE BAR SHOWN

NEW FULL HEIGHT WALL AT BACK BAR

EXISTING OFFICE DOS

6'X6' CUBE OPEN

NEW OFFICE GM

NEW CLOSET

REMOVE DOOR

6'X6' CUBE ACCI HR

6'X6' CUBE OPS MGR

CABINET

6'X6' CUBE FOM

CABINET

DEMO DOOR AT BUSINESS CENTER

DEMO WALLS FOR NEW CUBICLE

WALLS AT PLUMBING CHASE TO REMAIN

COPY

DEMO WALL AND DOOR

WORK TABLE

DEMO EXISTING TABLE - PROVIDE PROTOTYPE TABLE

PROTOTYPE SHOP - LAYOUT SHOWN - DEMO EXISTING SHOP

DEMO WALL NEW!



## Official Tax Payment Receipt

**Receipt No.:** 14098376 **Date and Time:** 01/02/2024 12:00 **Print Date:** 02/09/2024
**Receipt Details**

Parcel No.	Tax Year	TCA/District	Amount Applied	Unpaid Balance	Amount*	Description
20221101B	2023	038	\$59,970.67		\$0.00	Property Tax Principal
	2023	SJCG	\$25.00		\$0.00	County License Fees

**Payer Name and Address Information**

Name	Address	Tender Type	Amount Tendered
IND HOTEL PARTNERS, LLC	4045 E SUNSHINE STE 200 ,SPRINGFIELD ,MO65809	Personal Check	\$59,995.67

**Owner Name and Address Information**

Parcel No.	Name	Address	Since	To
20221101B	IND HOTEL PARTNERS, LLC	4045 E SUNSHINE STE 200, SPRINGFIELD, MO 65809	11/01/2023	Current

**Distribution of Districts**

Parcel No.	Tax Year	Agency	Amount
20221101B	2023	BLUE SPRINGS SCHOOLR-IV	48655.1230
	2023	BOARD OF DISABLED SERVICES	688.0037
	2023	JACKSON COUNTY	4915.9595
	2023	MENTAL HEALTH	915.7368
	2023	METRO JUNIOR COLLEGE	1710.4003
	2023	MID-CONTINENT LIBRARY	2797.1770
	2023	STATE BLIND PENSION	288.2697

**Motor Vehicles**

Parcel No.	Tax Year	Type	Make	Model Series	Model Year	Item ID	Plate No.	Name on Title 1	Name on Title 2
No Motor Vehicle Assets Found									

**Business Assets**

Parcel No.	Tax Year	Category	Purchase Year
20221101B	2023	MACR 15YR	2021
20221101B	2023	MACR 5YR	2021

20221101B	2023	MACR 5YR	2022
20221101B	2023	MACR 7YR	2021
20221101B	2023	MACR 7YR	2022

### Real Estate Legal Descriptions

Parcel No.	Legal Line	Line No.
------------	------------	----------

No Legal Descriptions Found

**\*Interest, penalties and fees will be assessed on any unpaid balance amount.** The amount of any unpaid balance shown on this receipt is the unpaid balance amount at the time the receipt is run, exclusive of such interest, penalties and fees. Changes in the taxable value may alter your unpaid balance amount.

Failure of this payment to clear your financial institution will void this receipt. A returned item fee and late penalty may be assessed.

Please verify with your financial institution that this payment has cleared.

Developed by Aumentum Technologies.  
 @2005-2020 All rights reserved.  
 Version 4.5.0.0

# City of Independence, Missouri Business License

Expiration Date: 6/30/2024

Account #: 106219

Licensed Business:

HILTON GARDEN INN INDEPENDENCE  
19677 E JACKSON DRIVE  
INDEPENDENCE MO 64057

Business Type:

MERCHANDISE RETURNS

TINA MILLER  
IND HOTEL PARTNERS, LLC  
4045 E SUNSHINE, SUITE 200  
SPRINGFIELD MO 65809

Business will operate in conformity and subject to Ordinances of the City of Independence, Missouri and the Statutes of the State of Missouri.

  
Community Development Director

\* MISSOURI INDEPENDENCE

TAXATION DIVISION  
PO BOX 3666  
JEFFERSON CITY, MO 65105-3666



*Missouri*  
DEPARTMENT OF REVENUE

Telephone: 573-751-9268  
Fax: 573-522-1265  
E-mail: taxclearance@dor.mo.gov

IND HOTEL PARTNERS LLC  
4045 E SUNSHINE ST STE 200  
SPRINGFIELD, MO 65809-2847

DATE: 02/09/2024  
VALID THROUGH: 05/09/2024

### CERTIFICATE OF NO TAX DUE

MISSOURI ID: 27198227  
Notice Number 2045361060

To Supervisor of Liquor Control: The Department of Revenue, State of Missouri, certifies the above listed taxpayer has filed all required returns and paid all sales, use, or withholding tax due, including penalties and interest, and does not owe any sales, use, and withholding tax, as of February 8, 2024. This review does not include returns that are not required to be filed as of this date or that have been filed but not yet processed by the Department.

This certificate is only for the purpose of obtaining a liquor license and is not pursuant to Section 144.150, RSMo.

This statement only applies to sales, use, and withholding tax due and is not to be construed as limiting the authority of the Director of Revenue to assess, or pursue collection of liabilities resulting from final litigation, default in payment of any installment agreement entered into with the Director of Revenue, any successor liability that may become due in the future, or audits or reviews of the taxpayer's records as provided by law.

THIS CERTIFICATE REMAINS VALID FOR 90 DAYS FROM THE ISSUANCE DATE.

TAXATION DIVISION

State of Missouri	O'Reilly Hospitality, LLC	2431 N Glenstone, Springfield, MO 65803	162704, 162705
City of Springfield, MO	Doubletree Hotel of Springfield	2431 N Glenstone, Springfield, MO 65803	BUS-0011813
Greene County, MO	Fairfield Inn & Suites	2455 N Glenstone, Springfield, MO 65803	28687, 28688
State of Missouri	O'Reilly Hospitality, LLC	2455 N Glenstone, Springfield, MO 65803	250319, 250318
State of Missouri	O'Reilly Hospitality II, LLC	4155 S Nature Center Way, Springfield, MO 65804	195570, 234827
City of Springfield, MO	Hilton Garden Inn	4155 S Nature Center Way, Springfield, MO 65804	BUS2010-00926
Greene County, MO	Hilton Garden Inn	4155 S Nature Center Way, Springfield, MO 65804	27907, 27908
State of Missouri	O'Reilly Hospitality V, LLC	2541 Broadway Bluff Drive, Columbia, MO 65201	186867, 186657
State of Missouri	Glen44 Investments, LLC	3080 N Kentwood, Springfield, MO 65803	246702, 242086, 242087
City of Springfield, MO	Macadoodles Noth Springfield	3080 N Kentwood, Springfield, MO 65803	BUS2016-01429
Greene County, MO	Glen44 Investments, LLC	3080 N Kentwood, Springfield, MO 65803	26629, 27859, 27860
State of Missouri	OH-MD Republic, LLC	1439 US Hwy 60E, Republic, MO 65738	231579, 238067, 229825
Greene County, MO	Macadoodles Republic	1439 US Hwy 60E, Republic, MO 65738	28143, 28141, 28142
City of Republic, MO	OH-MD Republic, LLC	1439 US Hwy 60E, Republic, MO 65738	2850
Newton County, MO	O'Reilly Hospitality VIII-Joplin TPS, LLC	4026 S Arizona Avenue, Joplin, MO 64804	221065-C, 221066-C
City of Joplin, MO	Towne Place Suites	4026 S Arizona Avenue, Joplin, MO 64804	16-00028340
State of Missouri	RTT Hospitality, LLC	2009 S National Avenue, Springfield, MO 65807	224674, 224675
City of Springfield, MO	Towne Place Suites Spfd	2009 S National Avenue, Springfield, MO 65807	BUS2014-00917
Greene County, MO	Towne Place Suites Spfd	2009 S National Avenue, Springfield, MO 65807	28498, 28499
State of Missouri	Hilton Garden Inn - Independence	19677 East Jackson Dr., Independence, MO	2824841, 282842